

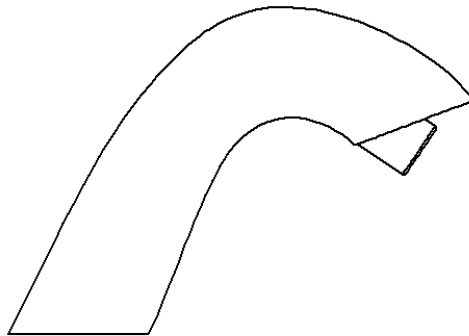

Product Instruction Manual
Vega



VEGAC
Curved Automatic Infrared Tap

Overview

Thank you for purchasing a Vega Tap. This tap is suitable for a wide range of washroom applications. It is ideal for use with Hyco Ara, Rho and Aquila instantaneous water heaters to provide optimum hand washing performance in washroom settings and for use with Hyco Speedflow and Powerflow unvented water heaters.

Key Features

- The tap is compatible with commonly available flow restrictor/spray head fittings and water and energy saving flow restrictors.
- Auto shut off to avoid misuse of water and energy.
- Simple touch free operation.
- Battery operated; no additional wiring required.
- Batteries included(4 x AA).
- Quick and easy installation and maintenance.
- Required hole diameter for mounting tap 32-35 mm – fits in a standard sink.

Please fully read these instructions before commencing installation and follow to ensure that installation and operation are simple and safe.

Important Safety Points



The tap has no water mixing capability and should be supplied by premixed/thermostatically controlled water, comfortable for hand washing. Recommended temperature range between 36-42°C



Not suitable for installation in locations where bright reflective surfaces may interfere with the motion sensor, e.g. sensor facing a mirror or stainless-steel surface.



Ensure any debris is flushed through the supply pipework before connecting the tap.

1. Installation



Do not install where any obstacle is within the sensor range.



Do not install where glass or other strong reflective material is on the opposing wall.



Ensure sensor is not damaged in any way.



All supply pipework should be thoroughly flushed before connecting to the tap to ensure any debris is removed.

- Select a suitable surface on which to mount the control box, check the flexible hose from the tap will reach to 'water outlet' of the control box before committing to final location.
- Remove the cover plate of the control box for access to the battery compartment, insert the supplied batteries.
- Connect the desired water supply to the 'water in' of the control box, pipework should be purged of any debris prior to connection.
- Turn on the water supply and inspect all joints for leaks when installation is complete.

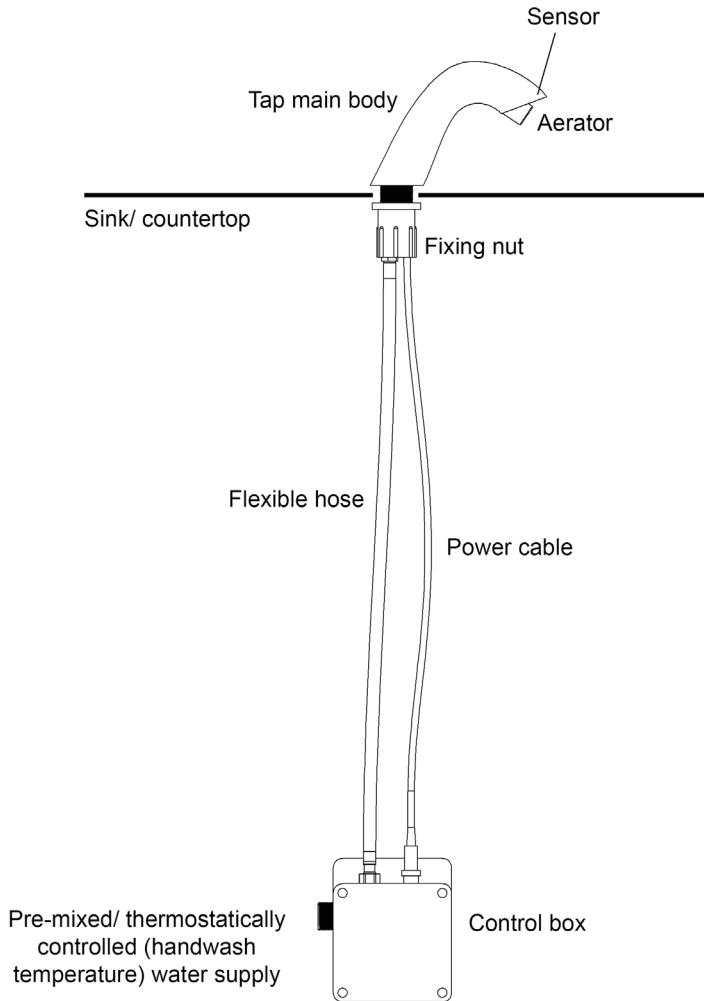

Diagram 1

2. Operation

- Place hands in line with the infrared sensor and water will flow from the spout.
- Remove hands to stop the flow.

3. Cleaning and Maintenance



Cleaning and user maintenance should not be carried out by children without supervision.

- To clean the tap, use non-abrasive cloths and detergents.
- Remove and soak the flow restrictor in descaling solution as and when required.
- If the tap stops working, change the batteries (4 x AA alkaline).

4. Specification

Power supply	4 x AA batteries
Dimensions	H130 x W55 x D160 mm
Protection class	IP24
Min operating flow rate	1.2 L/min
Min operating pressure	0.05 MPa (0.5 bar)
Max rated pressure	0.8 MPa (8 bar)
Water fittings	1/2" BSP



INFORMATION FOR CORRECT DISPOSAL OF THE PRODUCT IN ACCORDANCE WITH THE EUROPEAN DIRECTIVE 2012/19/EU.

At the end of its working life this equipment must not be disposed of as household waste. It must be taken to a local authority waste collection centre or to a dealer providing this service. Disposing of electrical and electronic equipment separately enables its components to be recovered and recycled to obtain significant savings in energy and resources. In order to underline the duty to dispose of this equipment separately, the product is marked with a crossed out dustbin.

5. Guarantee

This product is covered by a standard parts or replacement warranty for a period of 1 year from the date of purchase.

If there is a manufacturing defect within the warranty period we will send spare parts, repair and return the unit or, at our discretion, supply a replacement product. Incorrect installation, frost damage, the consequences of limescale deposits or failure to follow correct operating and maintenance instructions are excluded. Consequential costs such as labour charges or damage to fittings and surroundings are expressly excluded.

6. Contact Us

If you experience a problem with this product you should first contact our service department on 01924 225 200 before taking any further action. Experience has shown that issues can often be resolved without the need to return or uninstall the product.

Hyco Manufacturing Ltd
Normandy Court
Express Way
Castleford, WF10 5NR

hyco.co.uk

T 01924 225 200
F 01924 225 210
E sales@hyco.co.uk