

# Installation:

Rough wall opening: 323\*346\*155 mm (12.7\*13.6\*6.1 in).

1. Remove the front plate from the recessed box.

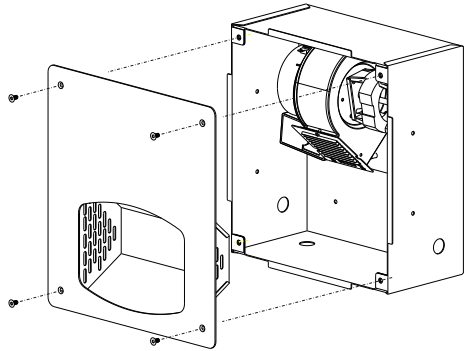

2. Remove the main unit from the recessed box.

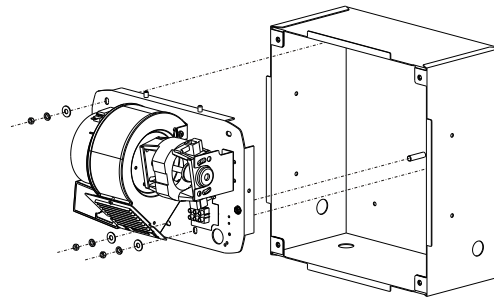

3. Insert the bushing into the side hole of the recessed box. Insert the recessed box into the wall and fix it.

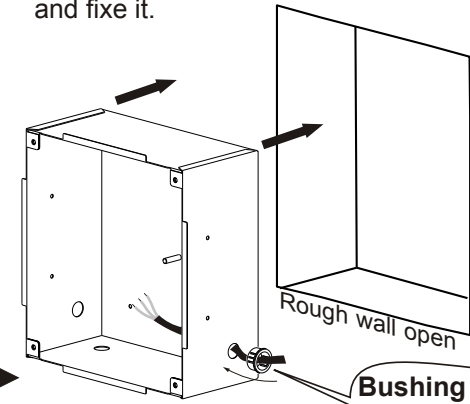

6. Attach the front plate back to the recessed box.

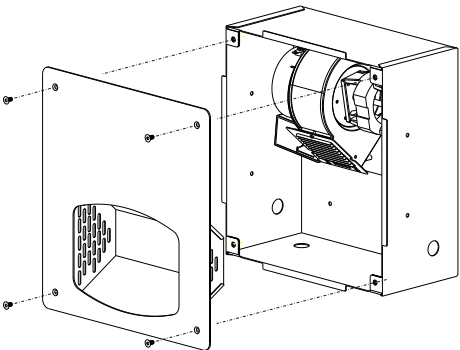

5. The wire connections are as follows :

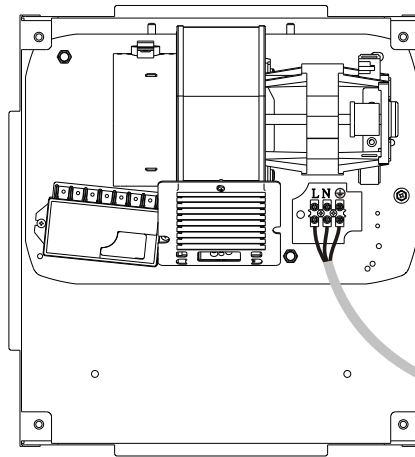

4. Attach the main unit back to the recessed box.

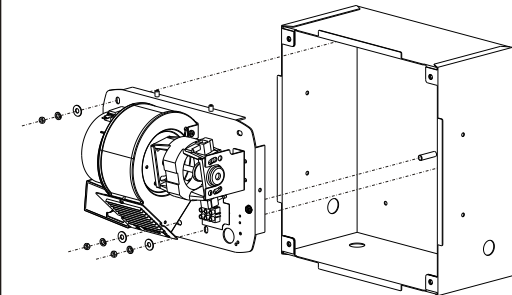

## Connections:

- A. Connect the live wire (colored red or brown) to the terminal block marked "L".
- B. Connect the neutral wire (colored black or blue) to the terminal block marked "N".
- C. Connect the ground wire (colored green and yellow) to the green screw marked "⊕".

# RECESSED HAND DRIER

## Specifications and Dimensions

Model	Volts	Watts	Amps	Housing Dimensions: mm (in)		
				W	H	D
CYCA26R	230/240Vac	2.2/2.6kw	9.2/12A	330mm(13")	350mm(13.8")	180mm(7")

### Recessed Box Diagrams:

Rough wall opening: 323\*346\*155 mm (12.7\*13.6\*6.1 in).

